

C.No.1548/2016/HRO/H1

TLP.No.247 /2016/HRO/H1

REF.No.Lr.No.01/GPR/2016, Dt.05-12-2016
of P.S. RAMAJIPET GP.

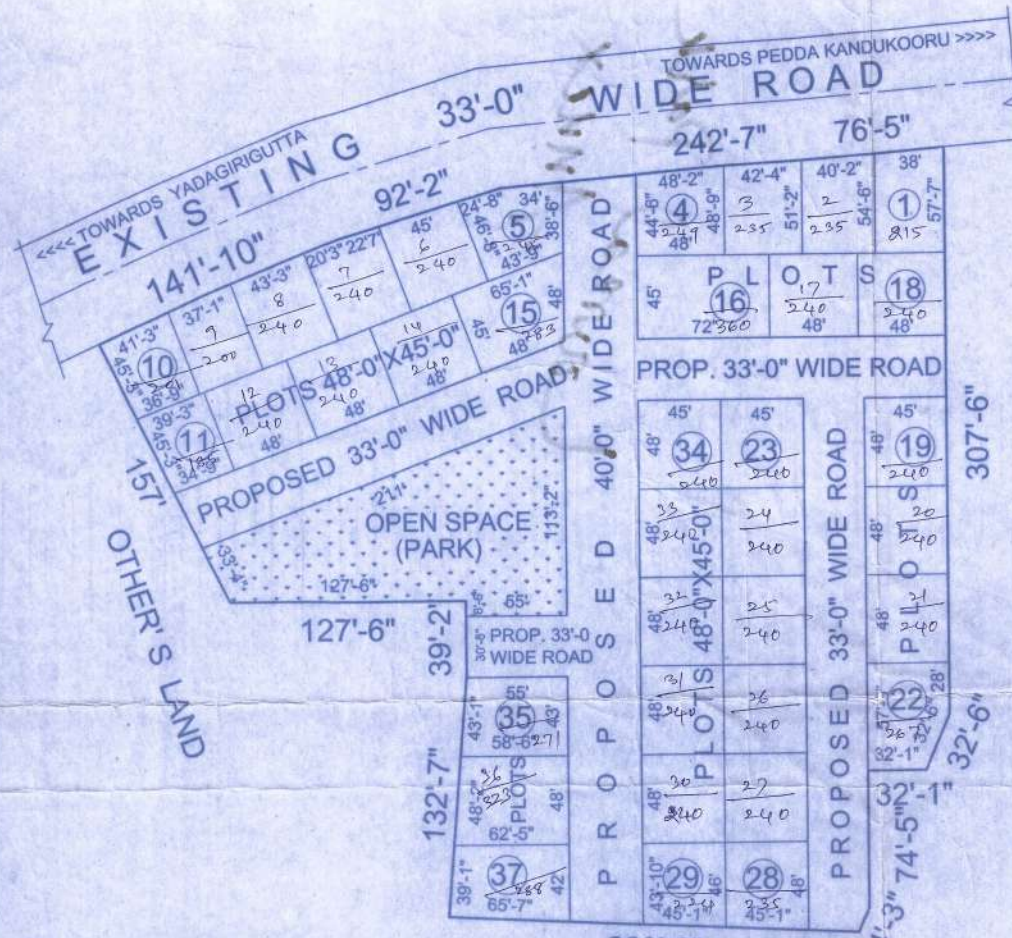

RAMAJIPET GRAMPANCHAYAT

EXTRACT VILLAGE MAP
SITE UNDER REFERENCE



REFERENCE:

- LAYOUT BOUNDARY
- EXISTING ROADS
- PROPOSED ROADS
- OPEN SPACE

LAYOUT AREA : Ac. 3.10
 % OPEN SPACE AREA (10.0%) : Ac. 0.310
 % OF ROAD AREA (28.4%) : Ac. 0.881
 NO. OF PLOTS : 37 NOS.

CAUTION:
 THIS LAY-OUT IS LEGALLY VALID ONLY ON ITS
 RELEASE / APPROVAL BY THE CONCERNED GRAM PANCHAYAT UNDER SECTION 121 OF
 A.P.P.R. ACT 1994 AND UNDER RULE 11 (3) OF G.O.Ms.No.67 P.R & R.D. DL26-02-2002
 AND ON FULFILMENT OF THE LAY-OUT CONDITIONS. ANY TRANSACTION PRIOR TO THE ABOVE IS ILLEGAL.

RAMAJIPET GRAMPANCHAYAT
 TECHNICAL LAYOUT PATTERN FOR RESIDENTIAL PLOTS
 IN SY. NO. 179 OF RAMAJIPET (V) YADAGIRIGUTTA (M)
 YADADRI DISTRICT, TELANGANA STATE.

SCALE: 66 FEET TO AN INCH

[Signature]
 ASSISTANT DIRECTOR

[Signature]
 REGIONAL DEPUTY DIRECTOR
 TOWN & COUNTRY PLANNING, HYDERABAD.

[Signature]
 ADM

[Signature]
 TOWN PLANNING ASSISTANT